

PROSPECT ELEMENTARY

Priscilla Anderson, Principal
anderson.priscilla@meridianschools.org

Phone 208-350-4000
Fax 208-350-4019

4300 N. Red Horse Way
Meridian, Idaho 83646

April 30, 2008

To the Board of Trustees:

Prospect Elementary is requesting approval for completion of our asphalt walking track, to extend all the way around our field. Completion of this project will allow us to further promote health and fitness activities, such as our walk/run program.

The attached map shows the existing track, and the area that needs to be completed. We have received a quote of \$8,118.00. The district maintenance department will obtain additional quotes.

The Prospect Elementary PTA has committed funds to cover the entire cost of this project, and has also budgeted for a minimum fund balance of \$2,500.00 to carry over to next Fall.

Thank you for your consideration.

Sincerely,



Priscilla Anderson, Principal

OK - Wayne Starnes 4-30-08

OK Joe Bergman 5/1/08

PROSPECT GROUNDS

← Area to be Completed
↓

RECESS AREA

FENCE

FENCE

REDHORSE WAY

HAVASU CREEK SUBDIVISION NO. 2

(A)

(B)

(C)

(C)

New Elementary School

Asphalt Play Area

Playground

COBRE BASIN SUBDIVISION NO. 2

THE BUILDING IS TO BE ORIENTED
PARALLEL AND PERPENDICULAR WITH
THIS PORTION OF THE PROPERTY LINE

SITE PLAN

SCALE - 30'-0"

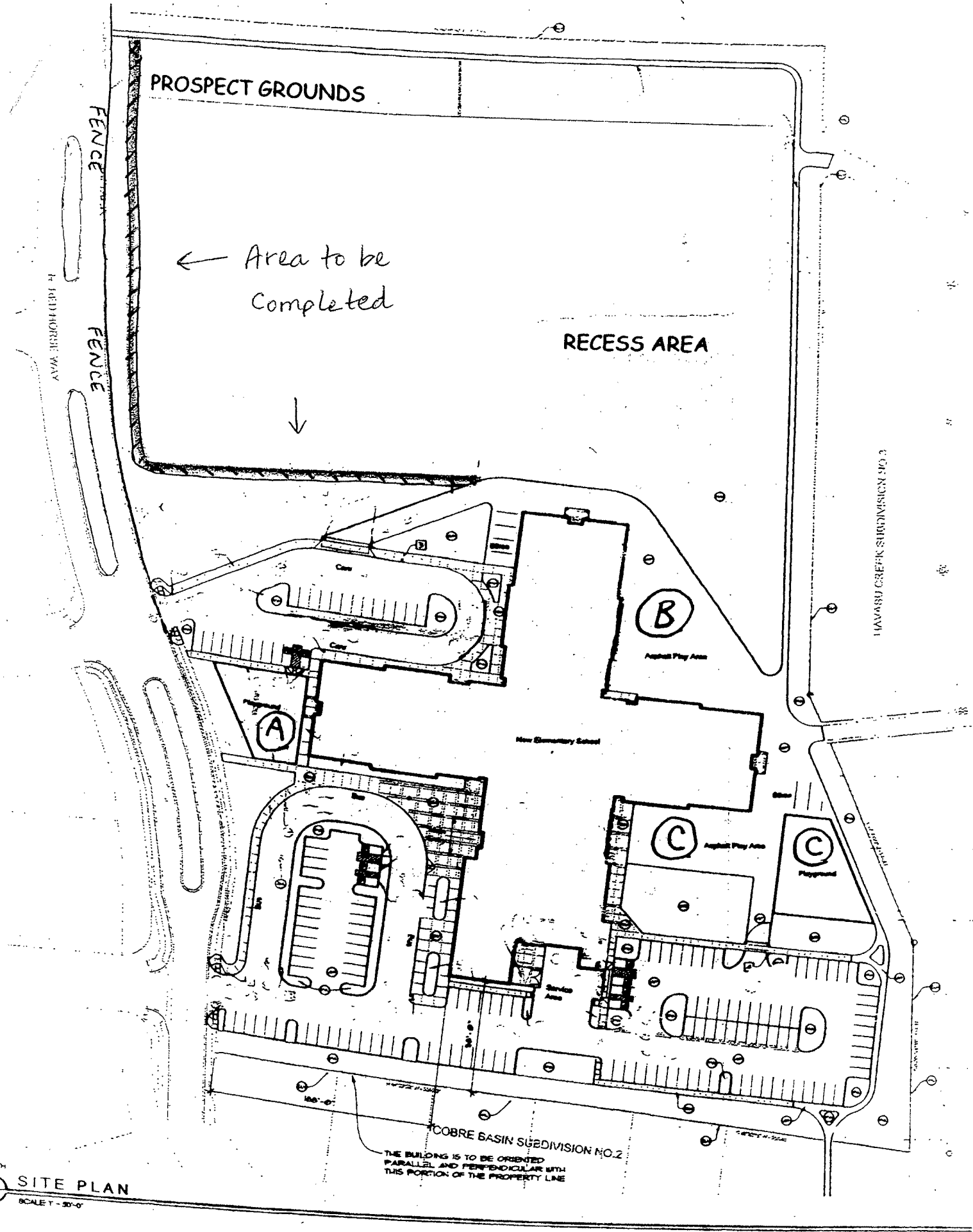



PROPOSAL

3104

- ◆ Sealcoating ◆ Line Striping ◆ Crack Sealing
- ◆ Pressure Washing ◆ Asphalt Patching
- ◆ Handicap Ramps ◆ Snow Removal

PAGE 1 OF 1

P.O. Box 190155 • Boise, Idaho 83719-0155
 Phone (208) 362-6525 • Fax (208) 362-1643

TO:
 Prospect Elementary
 Attn: Lisa Rawlings & Priscilla Anderson

PHONE	DATE
350-4000 Home 884-0040	Apr 15, 2008
JOB NAME/LOCATION	
Prospect Elementary Between Locust Grove & Meridian Road on McMillian Fax: 350-4019 Email: rawlingsfamily@cableone.net	

We hereby submit the following specifications and estimates for:

ASPHALT MAINTENANCE

BASE WORK

Excavate existing base material to install 4" of 3/4" roadmix over fabric paving material 4,920 s/f. 3,690.00

PAVING

Pave with 2 1/2" of asphalt compacted to 2" on approx. 3,690 s/f. 4,428.00

NOTES

- *This bid is based on current asphalt and fuel prices.
- *Due to the nature of work, unforeseen obstacles and issues may affect time and base materials estimated. Additional charges may apply.
- *Owner to apply sterilant before paving.
- *Contractor is not liable for delays due to weather conditions.
- *Area to be measured upon completion of work.

We Propose hereby to furnish material and labor -- complete in accordance with the above specifications, for the sum of:

Eight Thousand One Hundred Eighteen and 00/100 Dollars dollars (\$ 8,118.00)

Payment to be made as follows:

Due upon completion

Proposal/contract terms and conditions are listed on the back page. Please review prior to signing this proposal.

Acceptance of Proposal - The above prices, specifications and conditions are satisfactory and are hereby accepted. You are authorized to do the work as specified. Payment will be made as outlined above.

Date of Acceptance: _____

Authorized
Signature

Note: This proposal may be withdrawn by us if not accepted within 30 days.

Signature _____

Signature _____